

Lightings

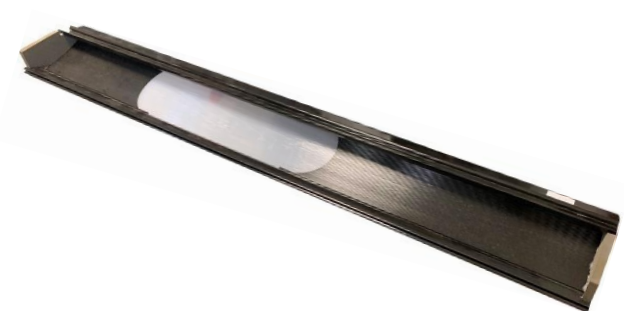

FOR MORE INFORMATION OR SAMPLES:

[www.extruco.com](http://www.extruco.com)

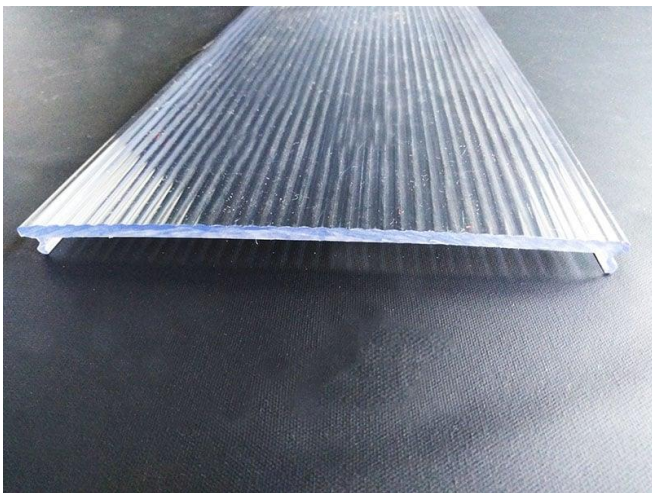

Allée de la Recherche 32  
B-1070 Anderlecht



[info@extruco.com](mailto:info@extruco.com)



+32 24 81 05 30

## LIGHTING APPLICATIONS

### PUBLIC TRANSPORT

**Sector:** Railway Lighting

**Scale:** Global Program

**Material:** Polycarbonate

- Specifications:**
- Co-extrusion
  - Machining operations
  - Non-diffusing paint
  - Complies with Fire & Smoke Standards

**Fire/smoke standards:**

-EN 45545-2



Bring your ideas to light!

Our Light & Plastic division specializes in the manufacturing of extruded plastic light diffusers. We process high-quality optical thermoplastics such as Polycarbonate or PMMA.

### GAS STATION

**Sector:** Illuminated Signs

**Scale:** Global Program

**Material:** Impact-Resistant Reinforced PMMA

- Specifications:**
- LED Lighting System
  - Color Match



### INFRASTRUCTURE

**Sector:** Metro Lighting

**Material:** Polycarbonate

- Specifications:**
- Striated Interior
  - Complies with Fire & Smoke Standards

**Fire/smoke standards:**

- R4 for Establishment  
Receiving the Public  
or Work



## LIGHTING SOLUTIONS

We transform high quality thermoplastics and with our production workshop equipped with 2 types of extrusion we offer a wide range of products in extrusion and co extrusion.

The experience and know-how of our employees allow us to extrude profiles of all shapes and sizes in all materials (PC, fiberglass reinforced PC, PMMA, ABS-PC, HDPE, PS, PVC, ...).



We offer you key solutions with a complete finishing and assembly service:

- Cut to length
- Machining, custom cutting
- End bonding
- Installation of seals and felts
- Installation of protective film
- Sub-contractor painting



### Packaging:

Available in standard and customs length. The profiles can be package in boxes or bags.

### Custom design:

By working with our teams, you will benefit from assistance in your new product development process. You will be able to shape your most ambitious ideas with the knowledge that you will be able to respond to any technical requirements.

### Fire/smoke standards:

- EN 45545-2
- R4 for Establishment Receiving the Public or Work
- PC Lexan 2034
- HL1, HL2, HL3 en 2 mm

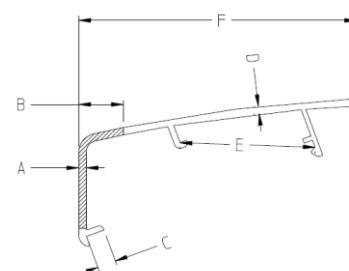

## TRANSLUCENT FOIL ON LED PROFILES



When the led is off, you get the effect of the foil;

When the led is on, light passes through slightly colored by the metallic transfer foil

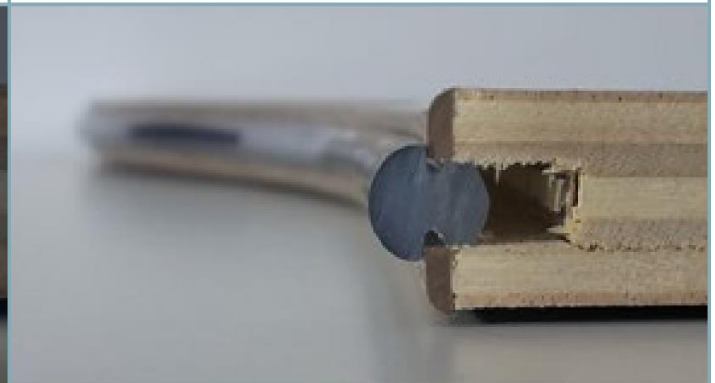
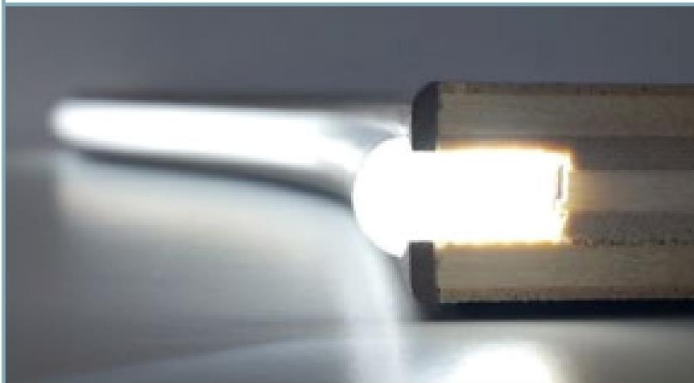

Translucent foil is available on both rigid and flexible LED profiles

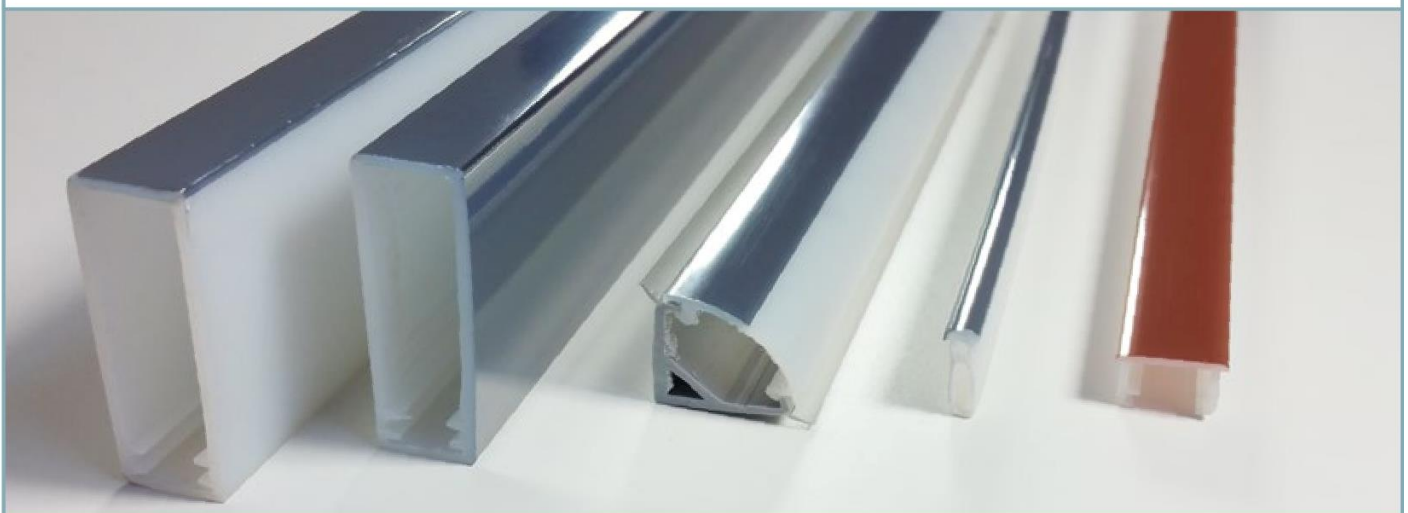

## S-TOUCH MODULE

### A TINY TOUCH SWITCH/DIMMER

Small capacitive touch module works with capacitive and conductive surfaces



#### Functions

on/off - dimmer - toggle - timer

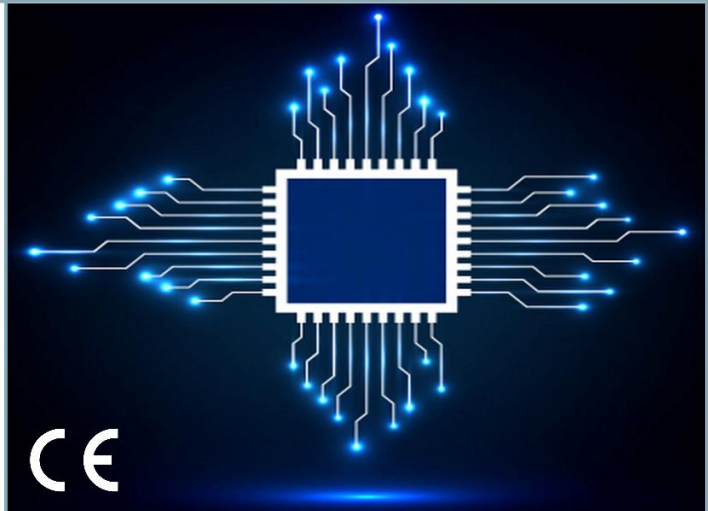

### SO SMALL IT FITS INSIDE LED PROFILE

#### Fine Tuning of

Performance  
Sensitivity  
Capacitance  
Substrate

#### Power

Maximum load 5A  
Power supply 12 - 24V DC



### USE OUR PROFILES AS A TOUCH LIGHT SWITCH

#### Available as

- 1) Printed Circuit Board only 35 x 10 x 5 mm
- 2) with leads soldered, and wrapped. 56 x 11,5 x 5,8 mm

#### Wire length:

LED out, power supply 120 mm sensor lead 200 mm

Works with BOTH capacitance surfaces

like our translucent film



and

conductive surfaces like an aluminum strip

## BANLU 2969



BANLU 2969

**Material and finishes**

ABS OPAL  
Transfer foil  
Translucent foil

**Packaging**

Available in standard and custom lengths

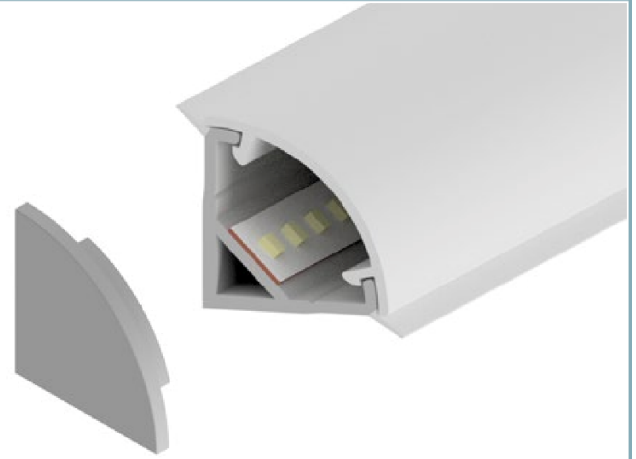

SOUP BANLU 2969  
(without soft lips)

**Material and finishes**

High impact PVC  
Plain colors

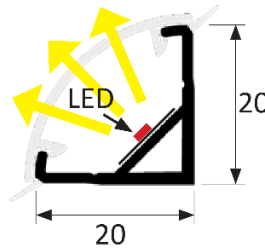

SOUP BANLU 2969 BIDUR  
(with soft lips)

**Material and finishes**

High impact PVC  
+soft PVC  
Plain colors

Mounting:



EMB BANLU 2969  
(with hole)



EMB BANLU 2969  
(without hole)

**Material and finishes**

ABS in plain colors  
Opal finishes  
Transfer foil  
Lacquer finish

## BANLU 1682 TCR

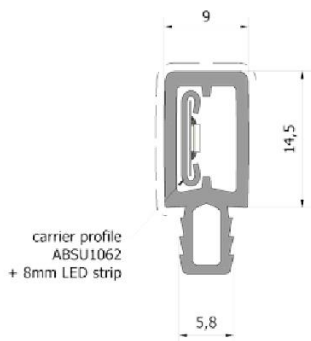

BANLU 1682 TCR

### Material and finishes

PVC CRISTAL  
Transfer foil  
Translucent foil



ABS U 1062 carrier profile  
with 8 mm LED strip

### Accessories

**ABS U 1062**  
LED carrier profile with  
8 mm wide LED strip.  
We also offer ABS U  
1062 without a LED  
strip inserted.

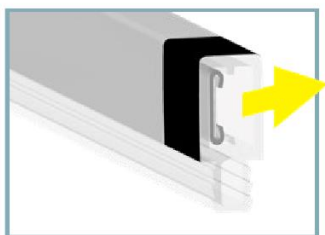

Decorative film, to orientate the light and give a decorative finish



**Packaging:** available in standard and custom lengths.

## ABS U 20107

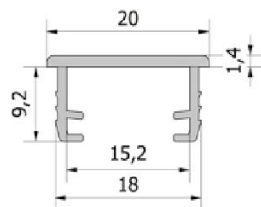

### ABS U 20107

Lighting cover in grooved panel

### Material and finishes

ABS OPAL

PVC CRISTAL ( clear) translucent foil

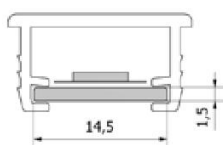

### BAN PVC 14515 with 10 mm LED strip ABS/PVC

### Accessories

#### BAN PVC/ABS 14515

LED carrier profile designed for insertion into ABS U 20107. LED strip not included.

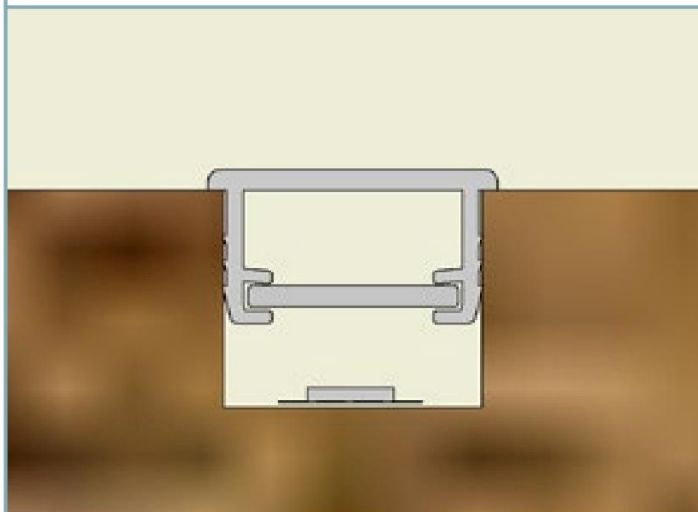
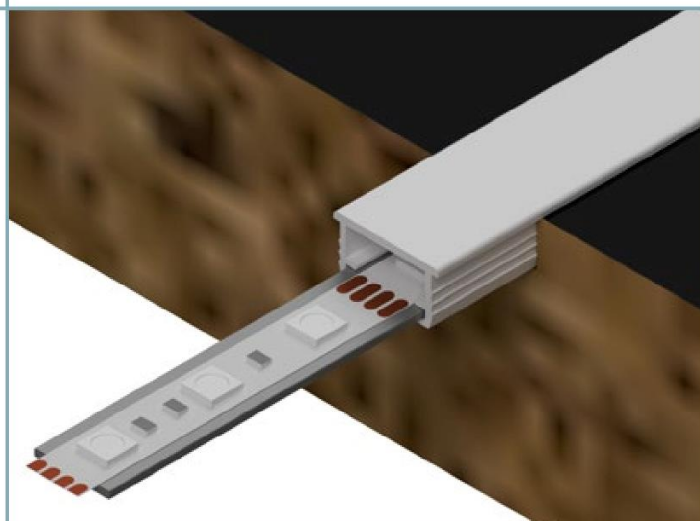

### Packaging

Available in standard and custom lengths

### Application suggestion

BAN PVC/ABS 14515 used as a light diffuser with the LED strip placed underneath



## ABS TUREC 1451 ERG

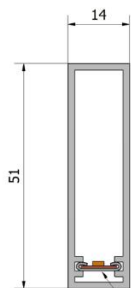

Carrier profile  
ABSU1062  
with 8mm led

ABS TUREC 1541 ERG

**Material and finishes**  
ABS OPAL  
Transfer foil  
Translucent foil

**Packaging**  
Max. length 4 m.

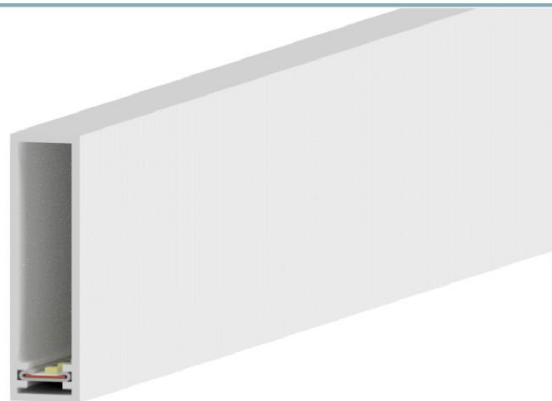

**EMB ABS TUREC 1451 ERG**

End cap with hole  
End cap without hole

**Material and finishes**  
Polystyrene  
OPAL finishes  
Plain colors

**Packaging**  
Plastic bag, in boxes



**ABS U 1062 carrier profile**  
(for use with 8 mm LED strip)

**Accessories**  
ABS U 1062  
LED profile with 8 mm  
wide LED strip. We also  
offer ABS U 1062 without  
a LED strip inserted.

**Packaging**  
Max. length 4 m.



## ABS U 1062

### ABS U 1062

LED profile designed for 8 mm wide LED strips. Facilitates LED strip Insertion into our galaxy profiles. We also offer ABS U 1062 with LED strip inserted.

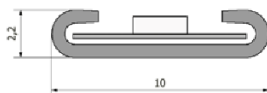

ABS U 1062 with 8 mm LED strip



ABS U 1062 can be used with  
 BANLU 1682 TCR  
 ABS U 15572  
 ABS TUREC 1451 ERG  
 ABS CLIPO 24138

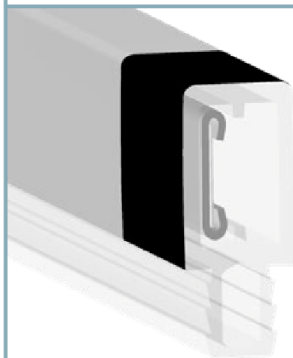

with BANLU 1682 TCR

**Material and finishes**  
 PVC crystal, in plain colors transfer foil

**Packaging**  
 available in standard lengths, or cut to order



with ABS CLIPO 24138

**Slightly SMALLER versions also available**

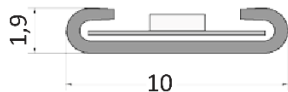

ABS U 1019

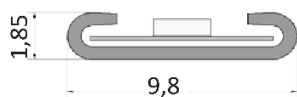

ABS U 9818



with ABS TUREC 1451 ERG

## ABS CLIPO 24138

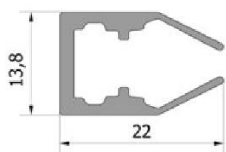

ABS CLIPO 24138  
with ABS U 1062 LED carrier  
profile inserted

### Glass shelf clip-on light

Projects LED light through a glass shelf  
for sparkling effect

Fits 6 and 8 mm glass

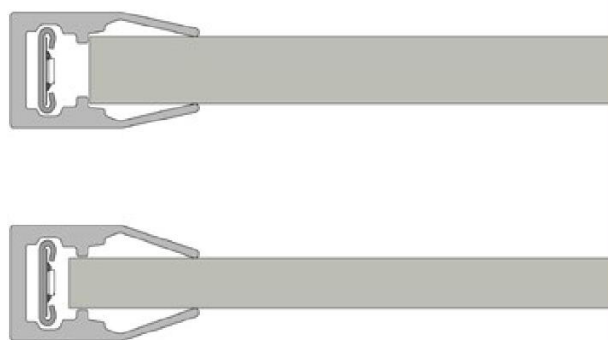

### Material and finishes

ABS  
Opal finish  
Plain colors  
Transfer foil

### Mounting

Clip-on

### Packaging

Available in standard and custom lengths

### Accessories

ABS U 1062

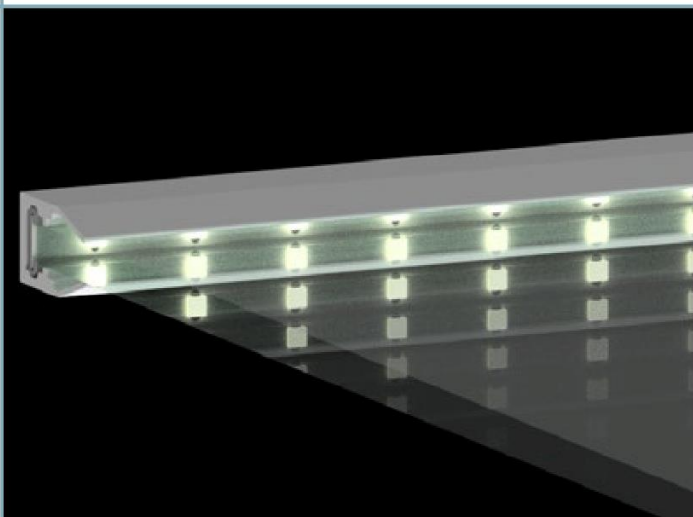

## ABS U 1062 T

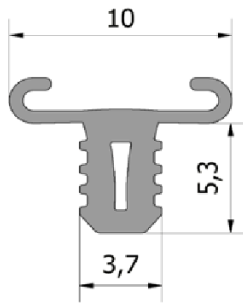

**ABS U 1062 T**  
LED carrier profile with 8 mm  
wide LED strip.

We also offer ABS U 1062T without LED strip inserted

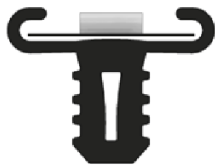

### Material and finishes

ABS  
Wain colors



**Packaging**  
available in standard and custom lengths

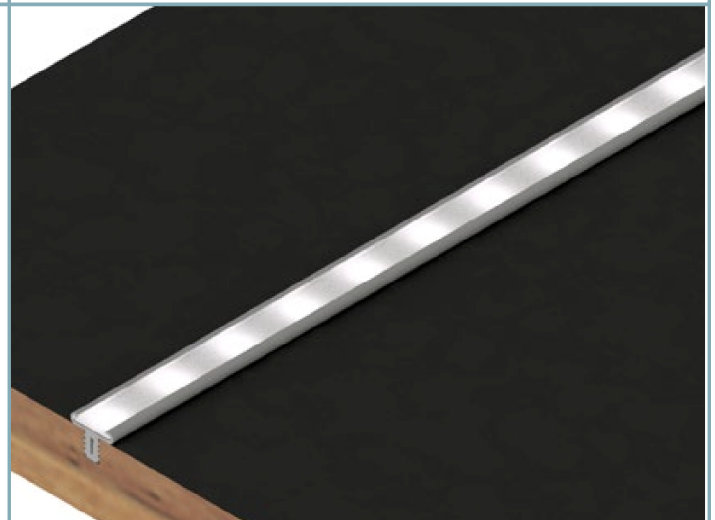

## ABS U 15572

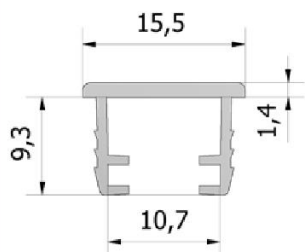

**ABS U 15572**  
Lighting cover in grooved panel

**Material and finishes**  
ABS OPAL  
PVC CRISTAL (clear)  
Translucent foil

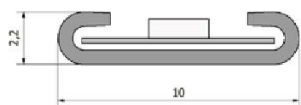
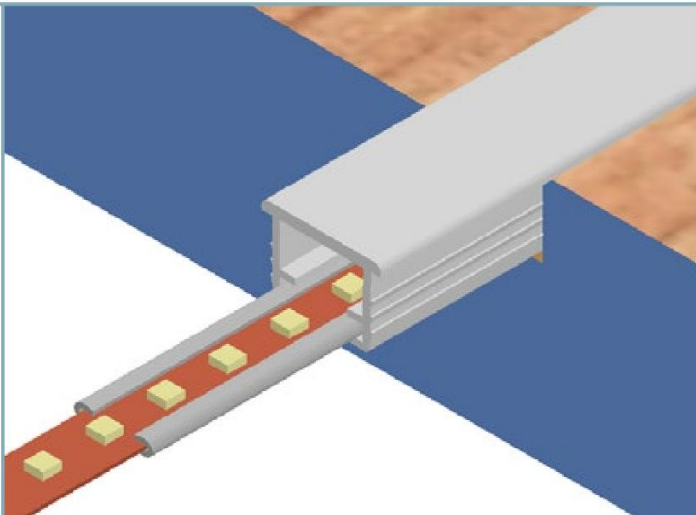

**ABS U 1062**  
with 8 mm LED strip

### Accessories

#### ABS U 1062

LED profile with 8 mm wide LED strip. We also offer ABS U 1062 without a LED strip inserted.



**Packaging:** available in standard and custom lengths

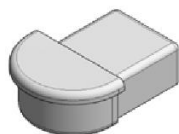

EMB PLAT ABS U 15572

### Accessories

EMB PLAT ABS U 15572  
end cap

**Packaging**  
plastic bag, in boxes

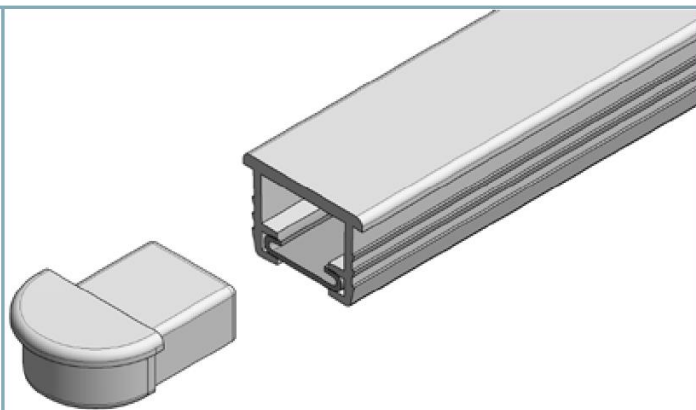

## FLEXIBLE T BARB LIGHTING

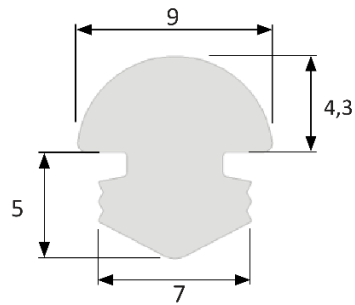

CRICOL 945/7 TDR

### Material and finishes

Flexible  
Transparent PVC  
Plain colors  
Translucent foil

### Accessories

5 mm LED strip  
Power supply  
S-Touch module (switch/dimmer)

### Packaging

available in standard and custom lengths

### Mounting

insertion in groove

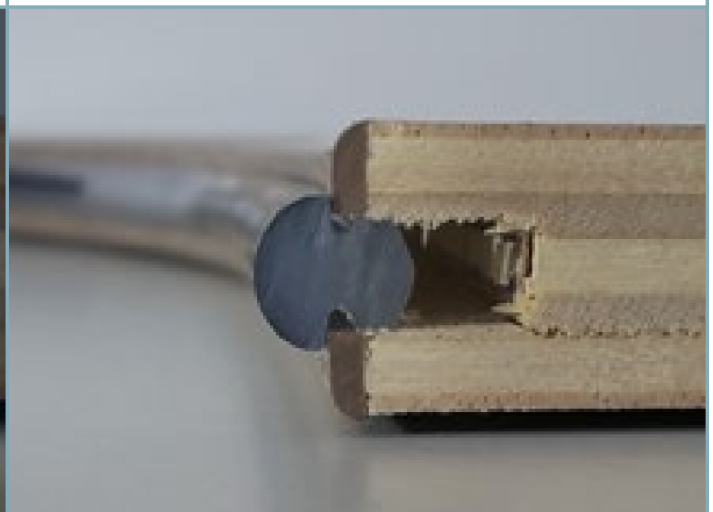
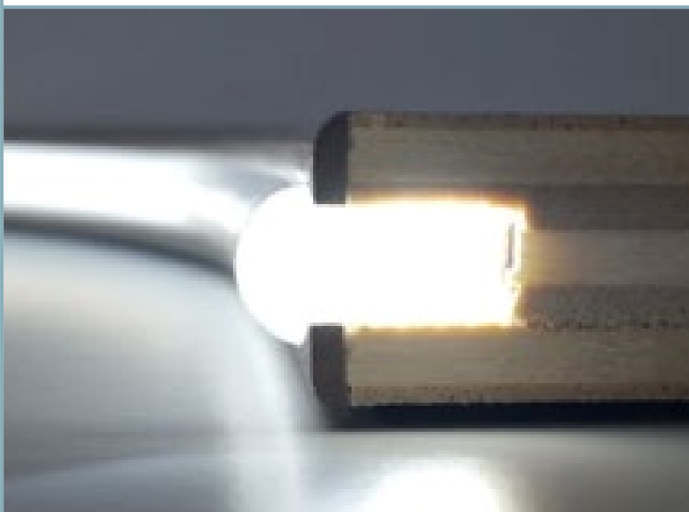
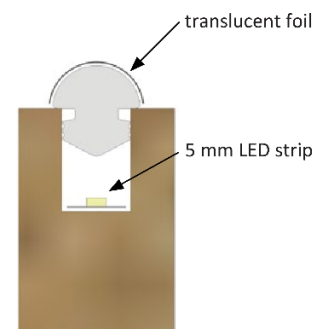

## PIED LUM 12050/25

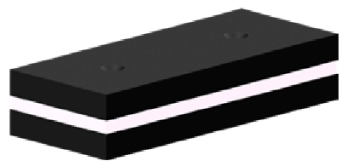

**Material:**  
ABS

**Finishes**

OPAL white (LED insert)  
Black (top and bottom material color)  
Lacquer finishes  
Translucent film on LED insert (chrome)

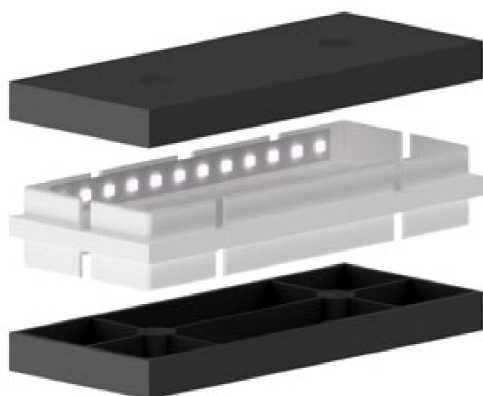
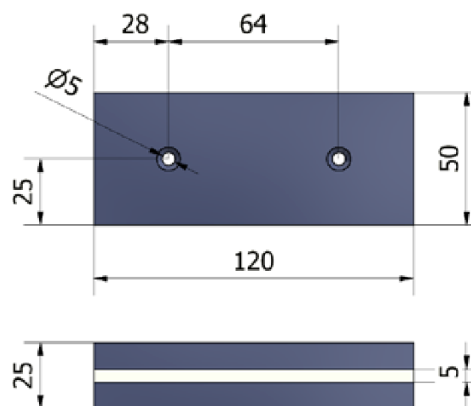

**Accessories**

Adapter 230 VAC in, 12 VDC 1A out with floor switch and multibloc.

One multibloc connects up to 6 LED applications.

**Cable length (standard)**

From power adapter to switch 170 cm  
From switch to multibloc 130 cm  
From LED to multibloc 200 cm.

Other lengths are possible



## ABS U 252512 - ABS L 2525

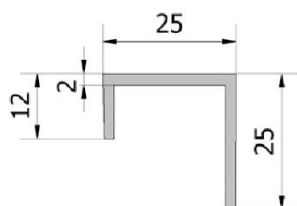

ABS U 252512

### Material and finishes

- ABS OPAL
- Transfer foil
- Translucent foil

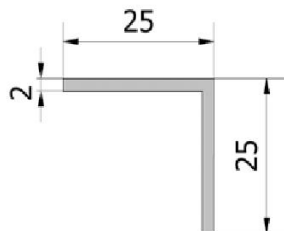

ABS L 2525



### Packaging

available in standard and custom lengths

### Mounting



Ambient lighting  
suggestion with  
ABS L 2525 ABS  
U 1062T

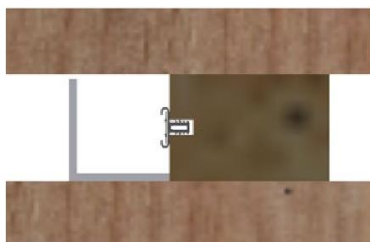

Ambient lighting  
suggestion with  
ABS U 252512  
ABS U 1062T

